

New Construction Pan with Adjustable Bar Hangers Installation Instructions



Joist Installation

1. Extend bar hangers between joists, placing automatic leveling flange under edge of joist. Mount to joist using pre-installed nail (Fig. 1).
2. If the new construction pan is too large to initially fit between joists, remove bar hangers and switch them from the long side to the short side of the pan by bending tab out and sliding the bar hangers apart. Move bar hangers to the short side of the pan and slide them back together (Fig. 2).
3. If the bar hangers are still too long, they can be shortened without removing them from the pan. Insert a screwdriver into the C-channel half of the bar hanger and pry back and forth until it snaps off on the scored line. Then pry the end of the other half of the bar hanger back and forth until it snaps off at the designated spot (Fig. 3&4).
4. Follow step one to complete installation.
5. If desired, after drywall installation, install self tapping screws into drywall at locations of perforations to better secure pan to ceiling, help decrease the drywall from bowing in between joists and minimize fixture vibrations in seismic prone areas (Fig.5).
6. Follow luminaire installation instructions (supplied by others) as needed.

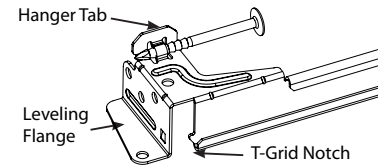

Fig. 1

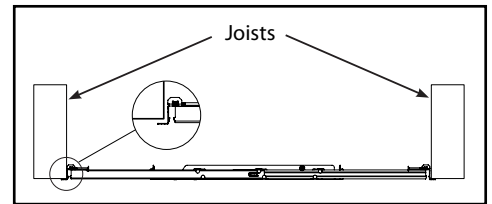

Fig. 2

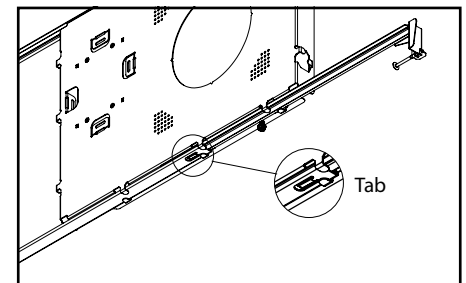

Fig. 5

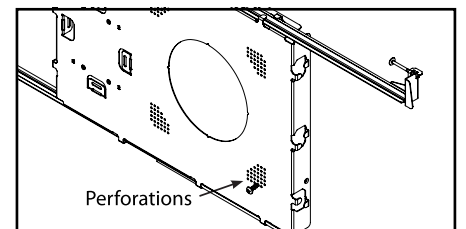

Fig. 6

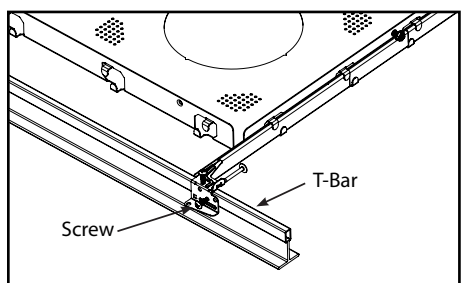

Fig. 3

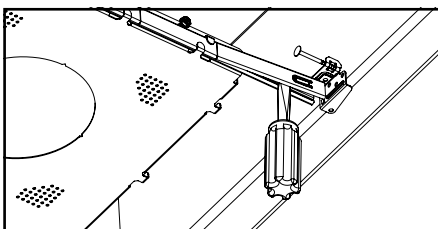
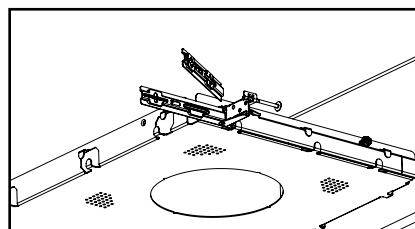

Fig. 4



T-Grid Installation

1. Locate center of fixture location in ceiling tile and cut round hole.
 - 4-3/16" for Halco product SKU# 89142
 - 6-1/8" for Halco product SKU#89143
2. Place ceiling tile in grid ceiling.
3. Snap new construction pan onto T-bars.
4. To secure the pan to the grid, install screws (provided by others) into screw holes (Fig. 6).