

## ⓔ SURFACE MOUNT LED EXIT SIGN EMERGENCY BATTERY BACKUP INSTALLATION & OPERATION INSTRUCTIONS

### Package Contents

| Part | Description            | Quantity |
|------|------------------------|----------|
| 1    | LED Edge-Lit EXIT Sign | 1        |
| 2    | Canopy                 | 1        |
| 3    | Hardware Bag           | 1        |

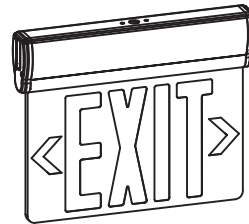

### Warnings and Cautions

## IMPORTANT SAFEGUARDS

### READ AND FOLLOW ALL SAFETY INSTRUCTIONS.

When using electrical equipment, basic safety precautions should always be followed including the following

1. Before starting the installation, disconnect the power by turning off the circuit breaker or by removing the appropriate fuse at the fuse box. Using the light switch to turning the power off is not sufficient to prevent electrical shock.
2. Do not use outdoors.
3. Do not mount near gas or electric heaters.
4. Use caution when servicing batteries. Battery acid can cause burns to skin and eyes. If acid is spilled on skin or eyes, flush acid with fresh water and contact a physician immediately.
5. Equipment should be mounted in locations and at heights where it will not be subjected to tampering by unauthorized personnel.
6. The use of accessory equipment not recommended by the manufacturer may cause an unsafe condition.
7. Do not use this equipment for other than its intended use.
8. All servicings should be performed by a qualified personnel only.
9. Allow battery to charge for 24 hours before first use.

## SAVE THESE INSTRUCTIONS

### ELECTRICAL CONNECTIONS

- Make the proper supply wire connections.
- If using 120VAC, connect the black and white wires to the building utility.
- If using 277VAC, connect the orange and white wires to the building utility.
- Cap off unused wires. In all cases, use standard wire nuts to connection to wires.

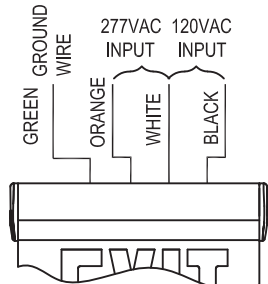

### DETERMINE DIRECTION

- If need indicator, remain indicator and remove instruction film.
- If no need indicator, remove indicator and instruction film together.



### RED AND GREEN COLOR CHANGEABLE

1. This product default setting is red color.
2. Slide the knob of slider switch to another side, then change to green color.

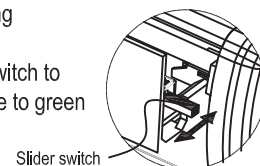

Slider switch

## Mounting Instructions

**NOTE:** First turn off electricity.

### Surface Ceiling & Wall Mounting

1. Attach crossbar to junction box.(TM8#-32\*-1)
2. Use screwdriver open front cover to connect battery connector.
3. Red exit sign can change to green exit sign if need (See *RED AND GREEN COLOR CHANGEABLE*).

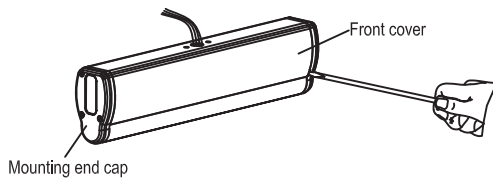

4. Feed AC supply wires through canopy center hole.
5. Assemble canopy onto main body assembly with (2) PM4\*12 screws(supplied) and make proper wire connections. (See *ELECTRICAL CONNECTIONS*).
6. Use (2) PM4-40 screws (supplied) tighten canopy to crossbar.

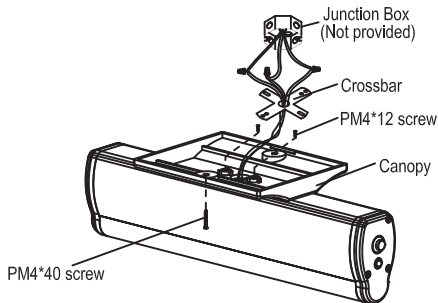

7. Insert EXIT panel into main body assembly gently. If EXIT panel is for single face, make sure EXIT letter direction is right.



8. Determine direction for chevron placement. (See *DETERMINE DIRECTION*)

9. The unit can be installed on any surface, you may rotate the EXIT panel in any angle from 0° to 180°, Ceiling mounting rotate 90° become Wall mounting.

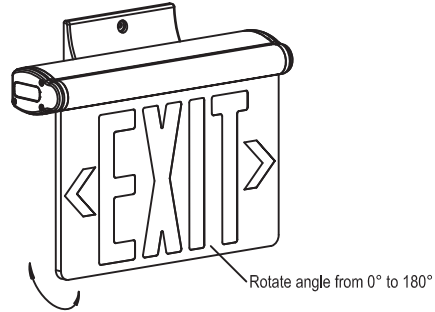

### Surface End Mounting

1. Attach crossbar to junction box.
2. Use screwdriver open front cover to connect battery connector.
3. Red exit sign can change to green exit sign if need (See *RED AND GREEN COLOR CHANGEABLE*).
4. Remove the hole plug from mounting end cap.
5. Pull out all AC supply wires and feed wires thru the center holes of mounting end cap and then canopy.
6. Reference 5 - 9 step in surface ceiling & wall mounting above for surface end mounting.

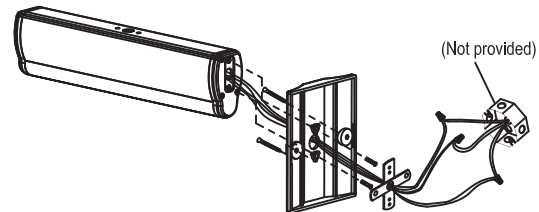

### MAINTENANCE

Battery have to recharge if product keep in stock over 9 months, detail manual refer "BATTERY STOCK AND RECHARGE GUIDELINE". The equipment should be tested regularly in accordance with local codes. Replace batteries as needed if discharge time do not achieve 90 minutes.

### OPERATION

Press the test button , unit will be illuminated by battery backup and the LED indicator will be turned off. Release the test switch, LED indicator will be turned on

### TROUBLE SHOOTING GUIDE

If LED heads or LED indicator does not illuminate, check the following:

1. Check AC supply-verify that unit has 24 hours AC supply.
2. Battery connection.
3. Discharge battery and charge for 24 hours and then retest
4. If above trouble shooting hints do not solve the problem, contact factory for assistance.